



1. A can complete a piece of work in 25 days. B can complete the same piece of work in 50 days. If both of them start together but A leaves after five days then at the end of 10 days. What percent of total work was completed?  
a) **40 %**                      b) 50 %                      c) 25 %                      d) 20 %
2. How many numbers are there from 500 to 750 (including both) which is neither divisible by 11 nor divisible by 13?  
a) 213                      b) 212                      c) **211**                      d) 209
3. If the length of sides of a rhombus is 9 cm and the length of the smaller diagonal is equal to the sides of the rhombus. Find the area of the rhombus?  
a)  $81\sqrt{3}$  sq.cm.                      b) 81 sq.cm.  
c) 40.5 sq.cm.                      d)  **$40.5\sqrt{3}$  sq.cm.**
4. The marked price of an article is Rs. 500. If two successive discounts of 50% and 25% are offered then the selling price is what percent of marked price?  
a) 42.5%                      b) 25%                      c) 32.5%                      d) **37.5%**
5. An article is sold at 150% profit on the cost price. If the same article was sold at Rs. 275 more then, the profit would have been 175%. What is the cost price of the article?  
a) Rs. 975                      b) Rs. 1050                      c) **Rs. 1100**                      d) Rs. 1000
6. The volume of cuboid block of stone is  $10368 \text{ dm}^3$ , its dimension are in the ratio 3:2:1. If its entire surface is polished at 2 paise per  $\text{dm}^2$ , then what is the total cost?  
a) Rs. 31.68                      b) Rs. 31.50                      c) Rs. 63                      d) **Rs. 63.36**
7. The length of two parallel sides of an isosceles trapezium is 20 cm and 10 cm. If height is 12 cm then what is the perimeter of the trapezium?  
a) 54 cm                      b) **56 cm**                      c) 58 cm                      d) 60 cm
8. Three containers of equal capacity containing the respective ratio of milk and

water in 4:5, 1:2 and 11:7. If all the three containers are emptied in a bigger container then what is the respective ratio of milk and water in the bigger container?

- a) **25:29**                      b) 25:28                      c) 23:29                      d) 23:27

9. The average age of 8 members of a family is 25 years. After 5 years, a new member included in the family then the average age is increased by 20 %. What is the age of new member?

- a) 25 years                      b) 35 years                      c) 20 years                      d) **30 years**

10. A sum of money is divided in three boys, A, B and C. The share of A is 20 % less than the share of B and the share of C is 200 % more than the share of A. If B received Rs. 250 then what is the difference between the share of A and the share of C?

- a) **400**                      b) 300                      c) 350                      d) 200

11. If two persons, P and Q started their journey at 8:00 am and 11:00 am in the same direction on the same day. If they meet each other at 5:00 pm then the speed of P is what percent of the speed of Q?

- a) 150 %                      b) 125 %                      c) **66.67 %**                      d) 75 %

12. What would be the difference between the Simple interest and the compound interest compounded annually on Rs. 25000 at the rate of 13 % per annum for 2 years?

- a) Rs. 421.5                      b) Rs. 423.5                      c) **Rs. 422.5**                      d) Rs. 427.5

13. If simple interest and compound interest on a particular sum for 2 year is Rs. 400 and Rs. 420 respectively, then find the rate of interest.

- a) 12.5 %                      b) **10 %**                      c) 15 %                      d) 20 %

14. If the sum of the reciprocal of three numbers is zero and the sum of the numbers is 13 then what would be the sum of the square of the numbers?

- a) 144                      b) 160                      c) 175                      d) **169**

15. If  $x^4 + \frac{1}{x^4} = 16 \frac{1}{16}$  then find the value of  $x^3 - \frac{1}{x^3}$

- a)  **$7\frac{7}{8}$**                       b)  $6\frac{7}{8}$                       c)  $7\frac{5}{8}$                       d)  $6\frac{5}{8}$

16. If  $X - \frac{3}{2\sqrt{2}+x} = 0$  then find the value of  $x^2 + \frac{9}{x^2}$

- a)  $12\sqrt{2}$                       b) 12                      c)  $14\sqrt{2}$                       d) **14**

The Best Coaching Institute For TNPSC, Bank, SSC, Police Exam, TET Exam, Railways Exams

17. A chord of length  $7\sqrt{2}$  cm make an angle of 45 degrees on the circumference of the circle Find the area of the circle?  
 a) 143 sq.cm.      **b) 154 sq.cm.**      c)  $169\sqrt{2}$  sq.cm.      d) None of these
18. What is the simplified value of  $\frac{2}{\tan a + \cot a}$   
 a) **Sin2a**      b) cos2a      c) tan2a      d) cot2a
19. What is the sum of the total number of females in branch A and the total number of males in branch?  
 a) 1250      b) 1258      **c) 1248**      d) 1235

**Directions: Study the following table chart carefully and answer the questions given beside.**

A public limited company has total five branches. The given table shows the percentage of employees work in the given five branches. The table also shows the ratio of males to females in the respective branches.

The total number of employees =4800

Branch	Percentage of employees	Males: Females
A	22%	1:1
B	15%	2:1
C	28%	4:3
D	27%	5:4
D	8%	5:3

20. Find the ratio of males in branch A to females in branch D?  
 a) 5:6      b) 11:3      **c) 11:12**      d) 9:13
21. What is the total number of males all together working in the given public – Sector Company?  
 a) 2476      **b) 2736**      c) 2976      d) 3486
22. The number of females in branch B is approximately what percent of the total number of employees in branch E?  
 a) 60%      **b) 62.5%**      c) 77.5%      d) 68.5%
23. What is the sum of the total numbers of employees working in branch C and branch D together?  
 a) **2640**      b) 2480      c) 2360      d) 2780

The Best Coaching Institute For TNPSC, Bank, SSC, Police Exam, TET Exam, Railways Exams

24. The area of a square field is 450 sq. km. if the diagonal of the square field is increases by 20% then find the new perimeter of the square field?  
 a) 72km                      b) 66km                      c)  $72\sqrt{2}$                       d)  $66\sqrt{2}$ m
25. If  $\operatorname{cosec} \theta = 4/3$ , find the value of  $4x \cos^2 \theta$   
 a) 1                      b) -2                      c) 2                      d) -1/2
26. REPAPER : REPAPER ::?  
 a) **GROWN: NWORG**                      b) WRONG : GNROW  
 c) TRAITER: RETRAIT                      d) FORTUNE: ENOTRUF
27. Direction : Select the related word/ letters/number from the given alternatives.  
 LETTER : 79 :: BITTER :?  
 a) **73**                      b) 78                      c) 75                      d) 79
28. Directions: Select the related word/letters /number from the given alternative.  
 Errata: Books:: Flaws:?  
 a) Charter                      b) Chapter                      c) Word                      d) **Speech**
29. Directions: Find the odd word/letter/number/pair of letters from the given alternatives.  
 a) Body                      b) **Letter**                      c) Closing                      d) Heading
30. Directions: Find the odd word/letter/number/pair of letters from the given alternatives.  
 a) EGF                      b) BDC                      c) **MQO**                      d) JLK
31. Directions: Find the odd word/letter/number/pair of letters from the given alternatives.  
 a) 7-56                      b) 8-64                      c) 3-24                      d) **9-81**
32. From the following alternatives select the word which can be formed by using the letters of the word.  
 IMMEDIATELY  
 a) DIALECT                      b) **LIMITED**                      c) DIAMETER                      d) DICTATE
33. **Direction:** A series is given with one term missing. Choose the correct alternative form the given ones.  
 2      4      10      12      26      ?

a) 52                      **b) 28**                      c) 56                      d) 58

34. C\_ac\_aa\_bc\_bcc

a) cabba                      **b) ccbbb**                      c) bbbbb                      d) cbacb

35. Select the missing number from the given alternatives.

7	4	3	?	31
8	3	5	4	52
9	3.5	2	4	7

a) 2 and 51                      b) 4 and 40                      c) 2.5 and 24                      **d) 2.5 and 32**

36. If '∞' means 'plus'. '%' means 'subtraction'. '\$' means 'division', and '#' means 'multiplication', what will come in place of question mark (?) in the given equation?

128\$ 4% 107 ∞ 23 # 4=?

a) 25                      b) 16                      **c) 17**                      d) 22

37. Pointing to the baby. Bhagat said, "She is only daughter of my grandfather's only child". How is the girl related to Bhagat ?

a) Daughter                      b) Niece  
**c) Sister**                      d) Cannot be determined

38. In a certain code language GARDEN is written as PBELFB How is PUBLIC written in that code language?

**a) ZVNAJJ**                      b) AJJZVN                      c) ZNVAJJ                      d) ZNVJJA

39. If BDF is coded as 222, then how will EHK be coded in that code language?

a) 444                      b) 523                      c) 419                      **d) 533**

40. Arrange the following words according to dictionary arrangement.

1. General    2. Gentle    3. Geniality    4. Genuine    5. Genesis

a) 1, 3, 4, 5, 2                      b) 5, 1, 2, 4, 3                      **c) 1, 5, 3, 2, 4**                      d) 4, 5, 1, 2, 3

41. Persons who belong to Delhi but not working as Doctors are represented by

a) C, D                      b) F, C                      **c) E, D**                      d) A, B

In the following diagram, three classes of population are represented by three figures. The triangle represents the Doctors, the square represents the Social workers and the circle represents the persons who belong to Delhi.

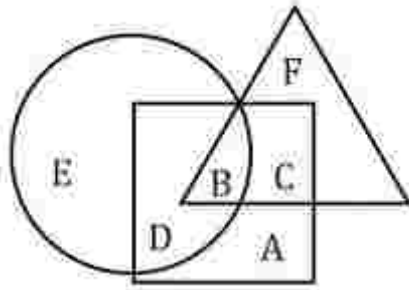

42. Person who is social worker. Who do not belong to Delhi work as Doctor is represented by

- a) C                      b) B                      c) E                      d) D

43. Directions: Two statements are given followed by two conclusions I and II. You have to consider both statements to be true even if they seem to be at variance with commonly known facts. You have to decide which of the given conclusions, if any, follows from the given statements.

**Statements:** All schools are colleges.  
Classrooms are Schools.

**Conclusions:** I. Some Classrooms are colleges.  
II. Some schools are Classrooms.

- a) Only conclusion I follows  
b) Only conclusion II follows  
c) Either conclusion I or II follows  
d) Both conclusions I and II follows.

44. **Directions:** Read the given information carefully and answer the questions given beside:

Mohamed walks 4 m towards east. and then he turns left and walks 5 m and then turns right and walk 7m. Then he takes right turn and walks 13 m. And again he takes right turn and walks 7m. In which direction he is facing from starting point?

- a) South –East      b) North –west      c) North –East      d) South –west

45. Five persons are standing in a line. One of the two persons at the extreme ends is a professor and the other a businessman. An advocate is standing to the right of a student. And author is to the left of the businessman. The student is standing between the professor and the advocate. Counting from the left the advocate is at which place?

- a) 1<sup>st</sup>                      b) 2<sup>nd</sup>                      c) 3<sup>rd</sup>                      d) 5<sup>th</sup>

46. Directions: A piece of a paper is folded and cut as shown below in the question figures. Indicate how it will appear when opened.

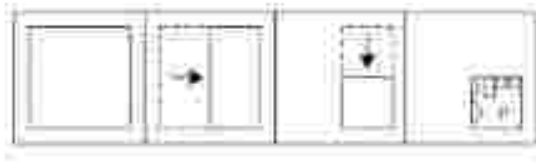

a)

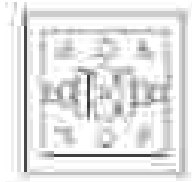

b)

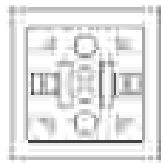

c)

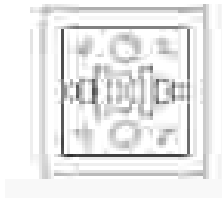

d)

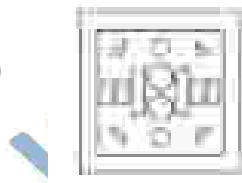

47. Directions: From the given options, select a figure in which the question figure is hidden / embedded.





a)



b)



c)

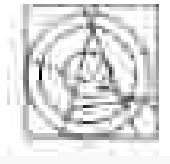

d)

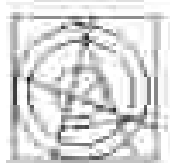

48. Directions: A mirror is placed on the line MN, and then which of the answer figures is the right image of the given question figure?



a)

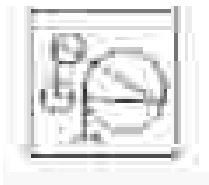



b)



c)



d)



49. A word is represented by only one set of numbers as given in any one of the alternatives. The sets of numbers given in the alternatives are represented by two classes of alphabets as in two matrices given below. The columns and rows of matrix I are numbered – form 0 to 4 and that matrix II are numbered from 5 to 9. A letter from these matrices can be represented first by its row and next by its column. e.g., 'A' can be represented b 01, 14, etc. and E can be represented by 55, 66 etc. Similarly. you have to identify the set for the word 'FACT'.

Matrix -

	0	1	2	3	4
0	P	A	G	T	Z
1	G	T	Z	P	A
2	Z	P	A	G	T
3	A	G	T	Z	P
4	T	Z	P	A	G

Matrix-II

	5	6	7	8	9
5	E	M	F	N	C
6	F	E	C	M	N
7	C	N	E	F	M
8	N	C	M	E	F
9	M	F	N	C	E

- a) 65, 11, 59, 03      b) 89, 43, 76, 24      c) **57, 14, 98, 32**      d) 78, 01, 67, 31

50. Directions: In this question, select a figure from amongst the four alternatives. Which when placed in the blank space of question figure would complete the pattern.

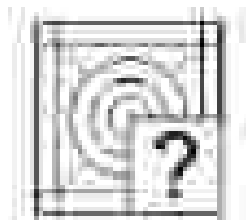

a)



b)



c)



d)

